

SECTION A-A

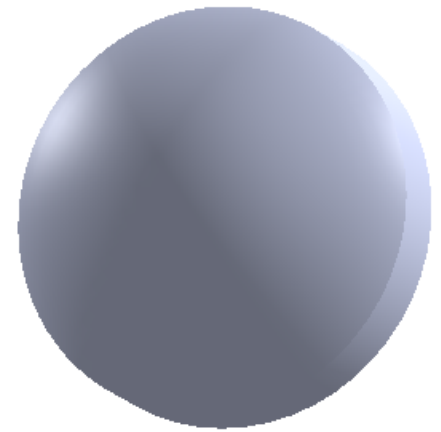

REVISIONS			
REV.	DESCRIPTION	DATE	APPROVED
A	Initial	1/6/2016	DF
B	Modified S2 CA	1/18/2016	DF
C	Irreg spec update	1/20/2016	DF
D	Coating update	2/18/2016	DF
E	Surface Quality to 60-40	2/25/2016	DF

Notes

Material: S-LAH60M

Power: < 4 Fringes

Irregularity: <0.2 μm PV

Coating: Coat both surfaces S1 & S2  
 AR R<0.5% @ 400-650nm ("A" coating)  
 or R<0.5% @ 620-1070nm ("B" coating)

Centration: 3 arcmin

Clear Aperture:  
 S1=9.0 mm S2=9.9mm

Surface Quality: 60-40 SD

Break sharp edges

1208 Sigma CT.  
 Rockwall, TX 75087  
 Ph: (972) 722-1064  
 Web: www.archeroptx.com



**PROPRIETARY AND CONFIDENTIAL**  
 THE INFORMATION CONTAINED IN THIS DRAWING IS THE SOLE PROPERTY OF ARCHER OPTX, INC. ANY REPRODUCTION IN PART OR AS A WHOLE WITHOUT THE WRITTEN PERMISSION OF ARCHER OPTX, INC. IS PROHIBITED.

UNLESS OTHERWISE SPECIFIED:		NAME	DATE
DIMENSIONS ARE IN MM		DRAWN	
TOLERANCES:		CHECKED	
FRACTIONAL ±		ENG APPR.	
ANGULAR: MACH ± BEND ±		MFG APPR.	
TWO PLACE DECIMAL ±		Q.A.	
THREE PLACE DECIMAL ±		COMMENTS:	
INTERPRET GEOMETRIC TOLERANCING PER:			
MATERIAL			
FINISH			
NEXT ASSY	USED ON		
APPLICATION		DO NOT SCALE DRAWING	

TITLE: Bi-Convex Asphere		
SIZE <b>B</b>	DWG. NO. P1105	REV <b>E</b>
SCALE: 7:1	WEIGHT:	SHEET 1 OF 1